

DN	Pipe OD(mm)	Tol. OD&Lenght	A	B	Sleeve C x Thickness	Bolts and nuts Qty.x Dia x length	Weight(kg)	WP(bar)
50	60.3	±0.8	89	365	250x6	2xM12x365	3.7	46
65	76.1	±0.8	155	365	250x6	2xM12x365	4.1	46
80	88.9	±0.8	153	365	250x6	3xM12x365	5.0	46
100	114.3	±0.8	178	365	250x6	3xM12x365	5.7	46
125	139.7	+1.6-0.8	228	365	250x6	4xM12x365	7.8	46
150	168.3	+1.6-0.8	256	365	250x6	4xM12x365	12.2	37
200	219.1	+1.6-0.8	313	365	250x6	6xM12x365	15.4	36
250	273.1	+1.6-0.8	370	365	250x6	6xM12x365	19.1	35
300	323.9	+1.6-0.8	421	365	250x6	6xM12x365	22.2	35
350	355.6	+2.4-0.8	452	365	250x6	6xM12x365	25.7	26
400	406.4	±1.6	503	365	250x6	8xM12x365	28.7	26
450	457.2	±1.6	554	365	250x6	8xM12x365	33.9	26
500	508	±1.6	605	365	250x6	10xM12x365	36.1	26
550	558.8	±1.6	655	365	250x6	10xM12x365	42	26
600	609.6	±1.6	707	365	250x6	10xM12x365	45.2	24
650	660.4	±1.6	757	365	250x6	12xM12x365	56.4	24
700	711.2	±1.6	812	365	250x6	12xM12x365	62.3	24
800	812.8	±1.6	914	365	250x6	14xM12x365	70.7	20
900	914.4	±1.6	1015	365	250x6	16xM12x365	75.8	20
1000	1016	±1.6	1117	365	250x6	18xM12x365	85.8	16
1200	1219.2	±1.6	1346	365	250x6	22xM12x365	135.8	16

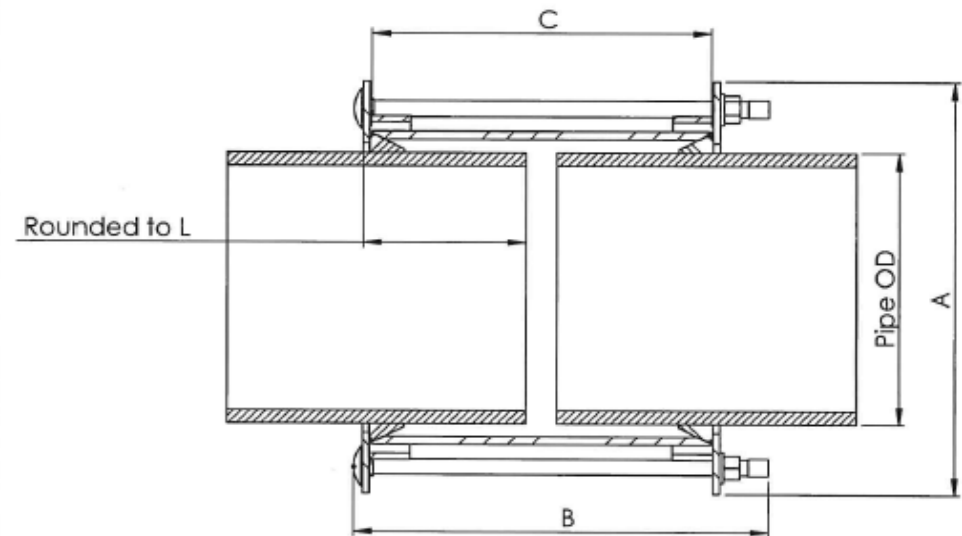
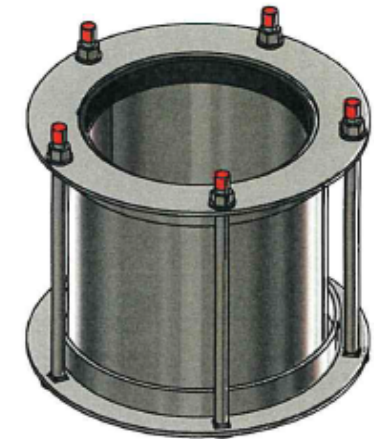

MERX TRADE B.V.
VALVES FOR MARINE AND INDUSTRY